

domus

USER MANUAL





INTENDED USE



Maximum occupancy per booth:

domus **S**



x 1

domus **M**



x 2

domus **L**



x 4

domus **XL**



x 6



Indoor use only



FLOOR REQUIREMENTS FOR DOMUS BOOTH INSTALLATION



Ensure the floor has sufficient strength and stability to support the booth's weight concentrated at the support points (wheels or stoppers).

domus **S**



distributed
across **4**
support points

domus **M**



distributed
across **6**
support points

domus **L**



distributed
across **6**
support points

domus **XL**



distributed
across **8**
support points

Ensure the floor is hard enough to prevent wheel marks when relocating the booth.

Ensure the floor surface is clean and level before beginning the installation.





PLACEMENT RECOMMENDATIONS FOR DOMUS BOOTHS



Maintain clearance around the booth (sides and ceiling) for proper ventilation.

Ensure sufficient space for proper door opening (outward opening).

Allow enough space to access the perimeter of the DOMUS booth (leveling stoppers, maintenance mobility).

To maintain a comfortable interior temperature, avoid placing DOMUS booths directly under heating or air conditioning units.



Prevent direct sunlight exposure to avoid a greenhouse effect and high interior temperatures.

The booth should be located near an electrical power source.





OTHER RECOMMENDATIONS





Ensure the installation site has a freight elevator for transporting packed booths.

Package volume and weight:



domus **S**

 216x52x126 cm
 303 kg



domus **M**

 218x50x105 cm
 520 kg

domus **L**

 216x69x171 cm
 680 kg

domus **XL**

 216x146x126 cm
 848 kg



Move booths only on solid, stable surfaces. Avoid slippery, uneven, or dangerously sloped floors.

Do not move booths with people or weight inside.

Avoid abrupt movements when moving booths equipped with screens or accessories.



Do not smoke inside the booths.

Always keep fire sources away from the booths.





INSTALLATION AND SETUP



Assemble the booth according to the assembly instructions. Refer to the assembly manual for personnel requirements per model.

Step 1

Position the assembled booth in the desired location (booths are equipped with wheels for repositioning within the office).

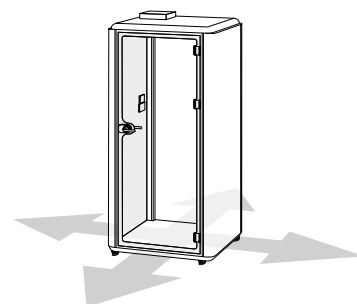

Step 2

Fix the booth in place by unscrewing the stoppers attached to the wheels until they are immobilized.

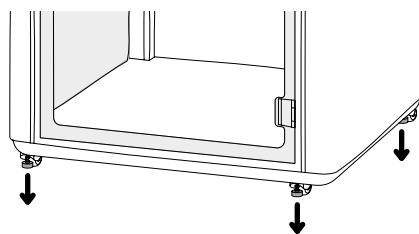

Step 3

Connect the booth to the power supply.

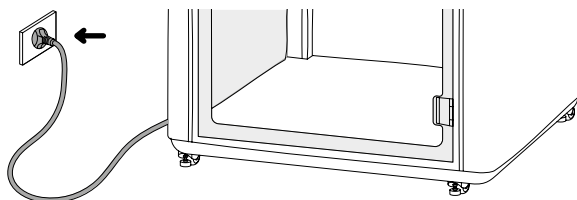

The booth can be repositioned within the office. Disconnect it from power and **screw** in the wheel stoppers to restore wheel mobility.

The floor must be level for booth relocation.

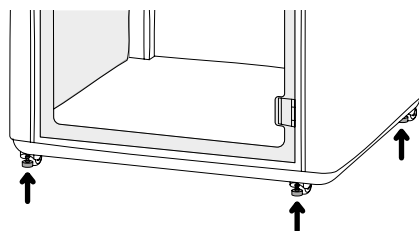



VENTILATION REGULATOR



Turn the ventilation control knob **counterclockwise** to close the air circulation (OFF).



Turn the knob clockwise to activate air circulation (ON) with adjustable intensity from **Maximum** (just after the OFF position) to **Minimum** (fully clockwise).

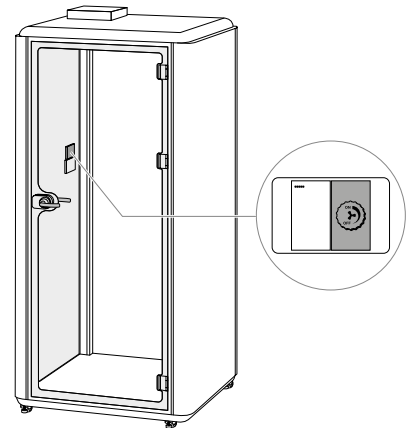

Turn the ventilation adjustment wheel **counterclockwise** until you hear a small “click” indicating that the air circulation is closed (OFF).



Comfort Recommendations:

Use moderate ventilation while inside the booth.

After extended use (multiple people, long duration), activate maximum ventilation. Complete air regeneration occurs in one minute at maximum power.

Turn off ventilation during extended periods of non-use (overnight, weekends, etc.).





LIGHTING OPERATION domus S



The ceiling has a recessed LED panel (**A**) activated by a switch located in the interior connector panel.

When the switch is ON, the light activates upon entry, triggered by the motion sensor. It turns off after 3 minutes of inactivity.

When the switch is OFF, the light remains off regardless of motion.

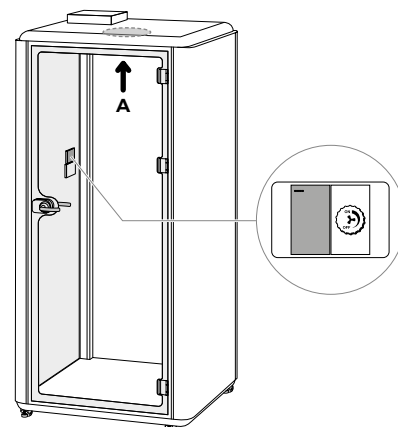

Comfort Recommendation:

Keep the switch ON for automatic lighting during frequent use periods.

Turn the switch OFF during extended non-use periods (overnight, weekends, etc.).



LIGHTING OPERATION domus M, L, XL



The ceiling has multiple recessed LED work lights (**A**) activated by the left switch in the interior connector panel.

Ambient LED strips (**B**) are also present in the ceiling, activated by the right switch in the interior connector panel.

When the switch is ON (**B**), the light activates upon entry via the motion sensor and turns off after 3 minutes of inactivity. When the switch is OFF (**B**), the light remains off regardless of motion.

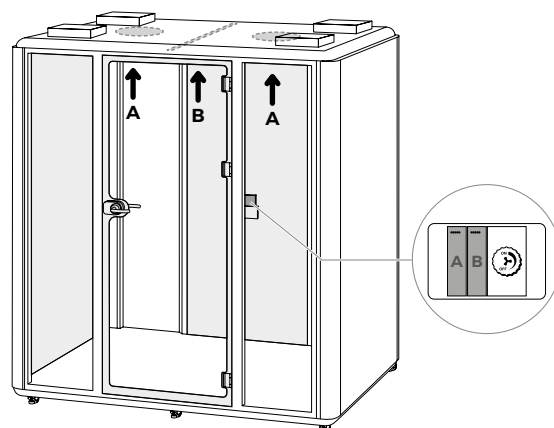

Comfort Recommendations:

Keep the **right** switch **ON** for automatic ambient lighting during frequent use.

Activate the **left** switch for work tasks requiring strong illumination.

Turn both switches **OFF** during extended non-use periods (overnight, weekends, etc.).





LOCK WITH KEY



The handle allows the booth to be locked with a key from the outside.

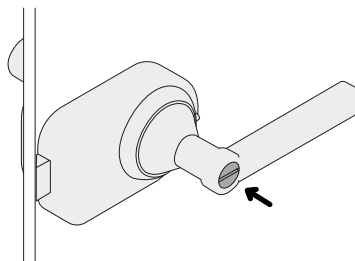

How to use the key lock:

Step 1

Insert the key into the slot in the DOMUS cabin.

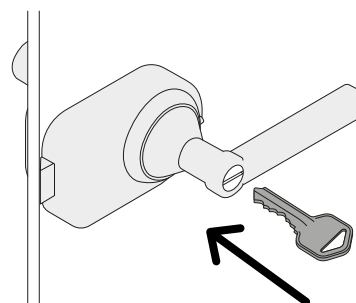

Step 2

Turn the key 90° clockwise.

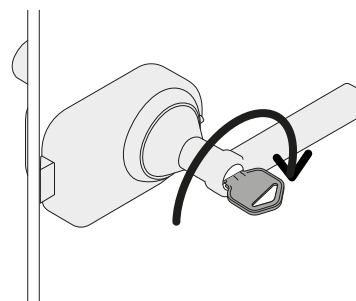

Step 3

DOMUS cabin closed.

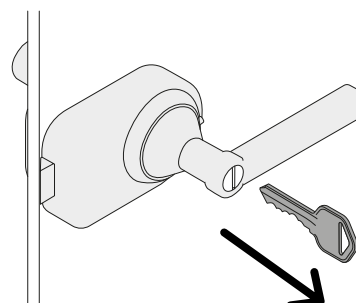



TECHNICAL DATA



Do not install high-power devices such as heaters or vacuum cleaners inside the DOMUS booths.

Maximum power consumption:

For 220V installations: 2200W total.

For 110V installations: 1600W total



CLEANING AND MAINTENANCE



Disconnect from power before performing maintenance or wet cleaning.



Use a soft cloth dampened with water and neutral soap. Dry with another soft, dry cloth. Do not use abrasive, solvent-based, caustic, or ammonia-based products.

PET surfaces: Most stains can be removed with abundant water. Let water flow through the PET to remove residues. Do not rub wet PET, as it may damage the material. For stubborn stains, use a recognized brand stain remover.

Clean upholstery with dry foam and other surfaces with a damp cloth.

For glass cleaning, avoid abrasive materials (sponges or abrasive detergents). Use a cloth dampened with soapy water or glass cleaner, then dry with a soft cloth.

Do not use cleaning agents containing natural or synthetic waxes or silicone oils.

Ensure ventilation channels are clean for proper airflow.

Avoid moisture accumulation, as it may damage construction and electrical materials.

