



DESKTOPS

 **Melamine top:** 25 mm of thickness. Recoated chipboard with melamine of 120 grs/m² in both faces with a density of 600 Kg/m³ ± 5 %. ABS edges all around the top with a bevel of 2 mm. Edges are fixed with melted glue and rounded in shape.

Finishes: graphite, white, grey, beech, maple, pear, wengue, light acacia, dark acacia, black, oak or dark oak.

 **HPL (High Pressure Laminate) top:** 25 mm of thickness. Recoated chipboard with decorative plastic laminate of 0,8 mm of thickness with a density of 600 Kg/m³ ± 5 %. ABS edges all around the top with a bevel of 2 mm. Edges are fixed with melted glue and rounded in shape.

Finishes: graphite, white, grey, beech, maple, pear, wengue, light acacia, dark acacia, black, oak or dark oak.



Tops are fixed to the frame of the desk with black-zinc DIN 7991 M6 x 65 screws.

Structure has 4 fixing drillings for the top.





FRAME



U-SHAPE FRAME



Steel cold laminated beam of 50 x 30 x 2 mm welded to two **square** steel columns of 55 x 55 x 1,5 mm.



Frame is welded with MIG system. Each beam has 2 fixing drillings for the desktops.



In the lower side of the frame there are ABS glides with levellers (M8 and $\pm 1,5$ cm height).



Available finishes: silver epoxy paint (RAL 9006), white (RAL 9016), graphite (RAL 7022) or black (RAL 9005).

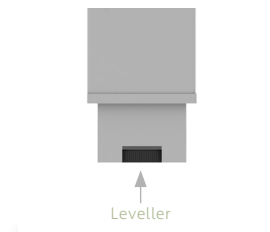
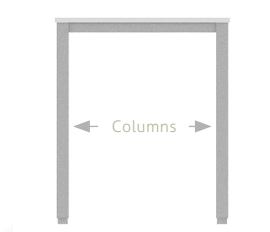
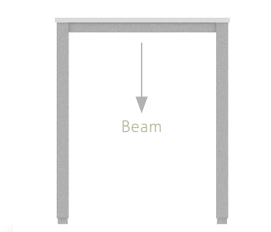

Reinforcement beam to fix both sides: rectangular steel tube of 50 x 20 of 1,5 mm.
Finish in silver epoxy paint (RAL 9006)



Steel brackets are welded in each side of the beam and joined to U-shape frame with black-zinc DIN 7991 M6 x 16 screws.

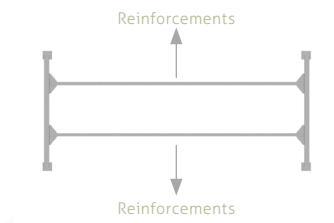
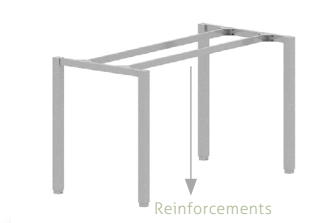

MEASUREMENTS (cm)

TABLES WITH SQUARE EDGES:

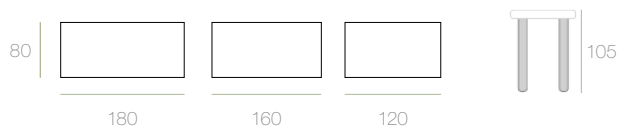

FINISHES

MELAMINE DESKTOPS

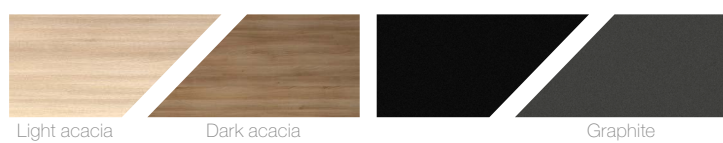

TEXTURED MELAMINE DESKTOPS



METAL FRAME

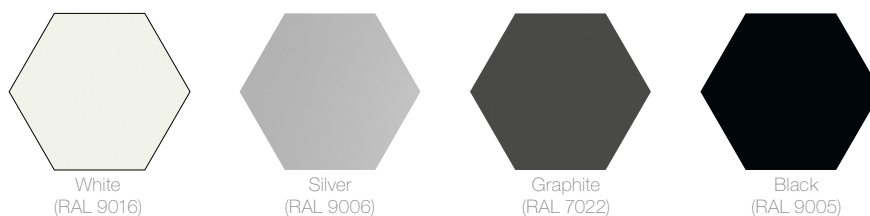



TABLES CERTIFICATES

UNE-EN 527-1:2011, UNE EN 527-2: 2017+A1:2019



CARE INTRUCTIONS

Clean the table and its components with a soft cloth and neutral detergent.



RECYCLABILTY AND TOXIC MATERIALS

This table does not contain any toxic material and its components are recyclable.



MATERIALS:

- Wood used to manufacturer desk tops is from certified forests managed in a sustainable way.
- 45% of this table materials are recycled.



PRODUCTION:

- Components and manufacturer packs are optimized to avoid chipboard remnant waste.
- Glues are not used. Assembly is mechanical.
- Production processes are optimized using fewer natural resources.



SHIPPING:

- Furniture is delived with our trucks. Routes are optimized to reduce CO₂ emissions.



USE:

- Modular range with many complements: it is possible to extendend or modify the table shape without replacements.
- All kind of replacements are available. It is the better way to repair damage parts of the desk and prolong its utility.



END OF LIFE:

- Desk is recyclable in a 98%.
- All the components can be disassembled easily and treat them separately for its recyclability.
- Desk packing materials are 100% recyclables.

